

DETAIL 1 SHIKRA CAP ASSEMBLY

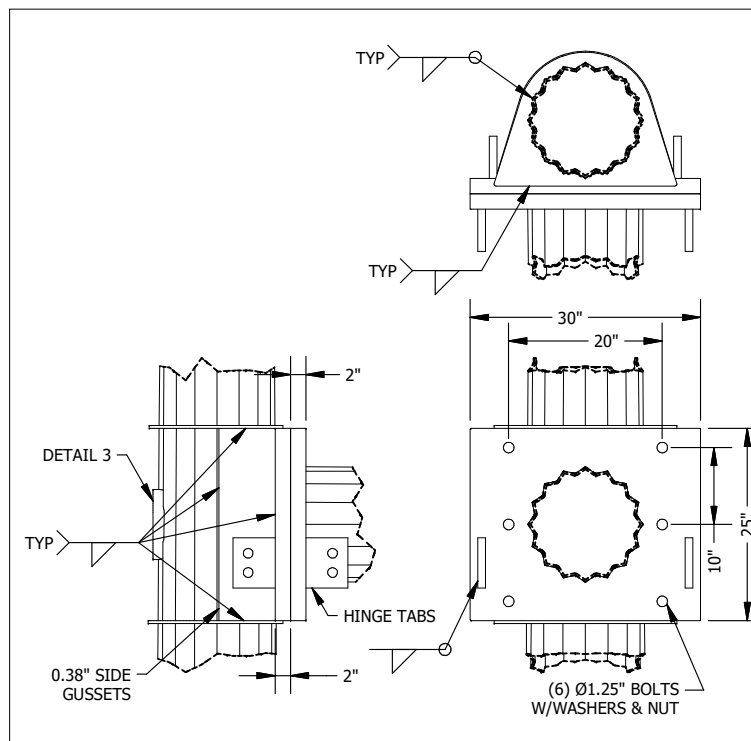

DETAIL 2 ARM SIMPLEX

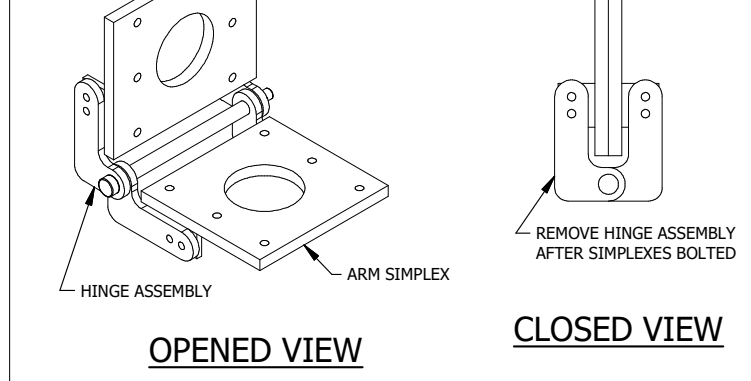

DETAIL 2 ARM SIMPLEX

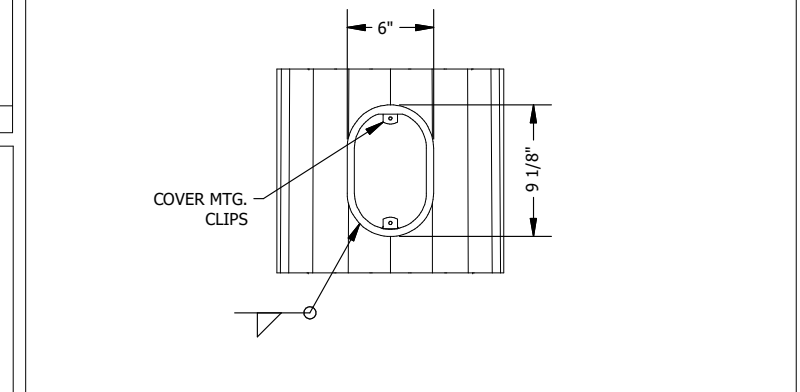

DETAIL 3 5 X 8 HANDHOLE

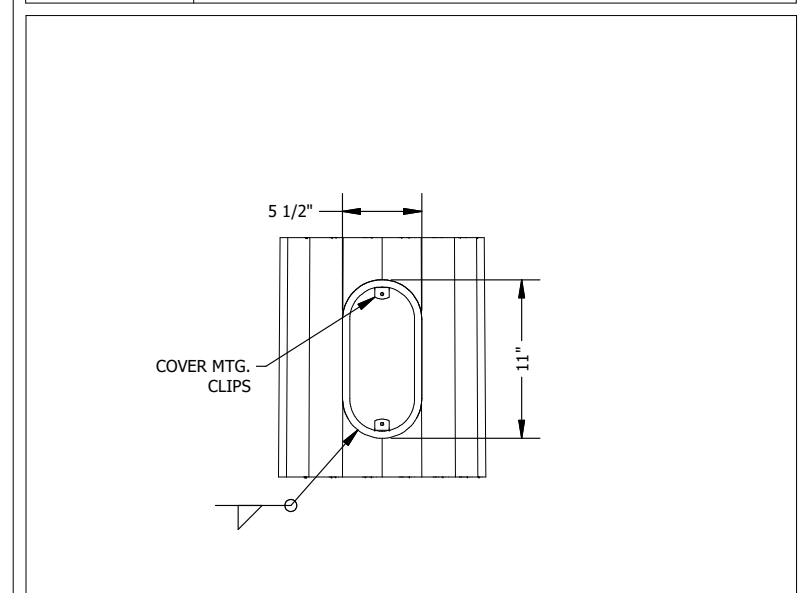

DETAIL 4 4 X 10 HANDHOLE

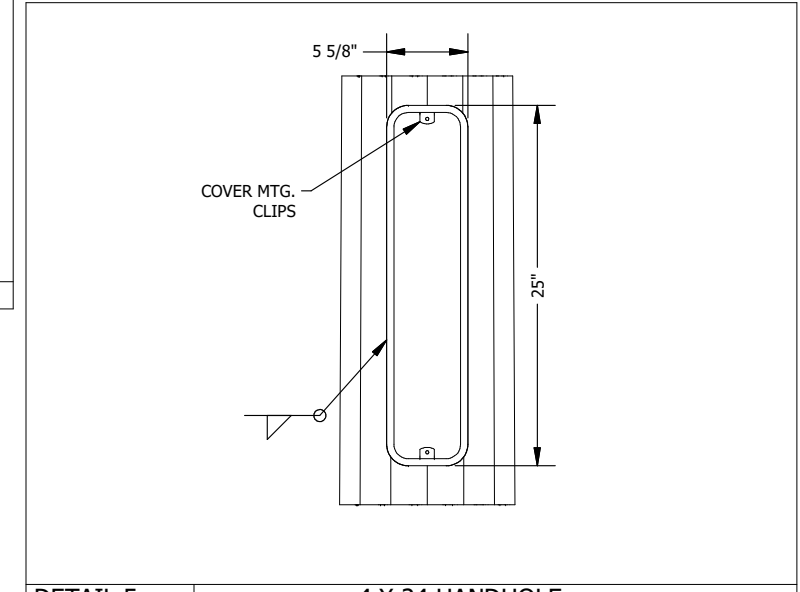

DETAIL 5 4 X 24 HANDHOLE

THE MAST ARM TRAFFIC STRUCTURES SHOWN ON THIS DRAWING HAVE BEEN DESIGNED IN ACCORDANCE WITH THE LOADING AND THE NOMINAL STRENGTH REQUIREMENTS OF THE 2015 AASHTO "LRFD SPECIFICATIONS FOR STRUCTURAL SUPPORTS FOR HIGHWAY SIGNS, LUMINAIRES AND TRAFFIC SIGNALS, FIRST EDITION" SLTS-1. THE WIND LOADS WERE CALCULATED FROM AN ULTIMATE WIND VELOCITY OF 170 MPH WITH A MEAN RECURRENCE INTERVAL OF 700 YEARS, AND A FATIGUE CATEGORY OF 1. THE FATIGUE LOADS WERE CALCULATED ON THE REQUIREMENTS OF SECTION 11 OF THE CODE, AND THE FOLLOWING DESIGN CONDITIONS:

- STRUCTURES ARE DESIGNED TO RESIST NATURAL WIND GUSTS BASED ON THE YEARLY MEAN WIND VELOCITY OF 11.2 MPH.
- STRUCTURES ARE DESIGNED TO RESIST GALLOPING-INDUCED CYCLIC LOADS.
- STRUCTURES ARE NOT DESIGNED TO RESIST GALLOPING-INDUCED CYCLIC LOADS.
- STRUCTURES ARE NOT DESIGNED TO RESIST GALLOPING-INDUCED CYCLIC LOADS DUE TO THE CUSTOMER SPECIFYING THE USE OF A VIBRATION MITIGATION DEVICE.
- TRUCK-INDUCED GUST LOADS ARE EXCLUDED PER THE REQUIREMENTS OF THE CODE.
- STRUCTURES ARE DESIGNED FOR TRUCK-INDUCED GUST LOADS, AS REQUIRED BY THE OWNER OF THE STRUCTURES.

**AASHTO 2015 SPECIFICATIONS**

MATERIAL DATA		
COMPONENT	ASTM DESIGNATION	MIN. YIELD (KSI)
POLE & ARM TUBE	A572	55
POLE BASEPLATE	A36	36
ANCHOR BOLTS	F1554 OR GR. 55	55
GALVANIZING - HARDWARE	A153	
SIMPLEX PLATES	A36	36
CONNECTING BOLTS	A325	
BASE CABINET RIMS	A572	50

POLE TUBE		BASE PLATE			ANCHOR BOLT					ARM TUBE			
BASE DIA. (IN)	TOP DIA (IN)	GAUGE OR THK. (IN)	ROUND "R" (IN)	BOLT CIRCLE "Y" (IN)	THK. "M" (IN)	HOLE/SLOT "Z" (IN)	DIA "K" (IN)	LENGTH "J" (IN)	HOOK "H" (IN)	THREAD LENGTH "U" (IN)	BASE DIA. (IN)	GAUGE OR THK. (IN)	LENGTH (FT)
17.00	14.90	0.25	32.00	23.00	2.50	1.75	1.50	54.00	6.00	8.00	15.00	0.25	18.88

REV	JWG 02/17/23	AAH 02/17/23	
	DRAWN BY-DATE	CHECK BY-DATE	DESCRIPTION

SOLD TO:	
SHIP TO:	
P.O. #:	
AGENT:	

JOB	BUS CHARGING FLUTED POLE DESIGN
TITLE	BUS CHARGER

VALMONT INDUSTRIES, INC. RESERVES THE RIGHT TO INSTALL VARIOUS, ENGINEER APPROVED, MATERIAL HANGING ACCOMMODATIONS TO FACILITATE THE MANUFACTURING PROCESS.



ORDER NUMBER:	568817-P1
PAGE NUMBER:	1 OF 2
DRAWING NUMBER	REV
	SC568817P1

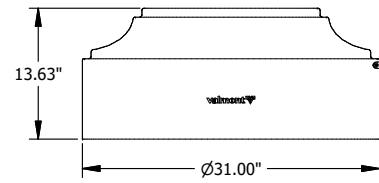

DETAIL 6 DECORATIVE BASE CL31AC

ALTHOUGH RARE, VIBRATIONS SEVERE ENOUGH TO CAUSE DAMAGE CAN OCCASIONALLY OCCUR IN STRUCTURES OF ALL TYPES. BECAUSE THEY ARE INFLUENCED BY MANY INTERACTING VARIABLES, VIBRATIONS ARE GENERALLY UNPREDICTABLE. THE USER'S MAINTENANCE PROGRAM SHOULD INCLUDE OBSERVATION FOR EXCESSIVE VIBRATION AND EXAMINATION FOR ANY STRUCTURAL DAMAGE OR BOLT LOOSENING. THE VALMONT WARRANTY SPECIFICALLY EXCLUDES FATIGUE FAILURE OR SIMILAR PHENOMENA RESULTING FROM INDUCED VIBRATION, HARMONIC OSCILLATION OR RESONANCE ASSOCIATED WITH MOVEMENT OF AIR CURRENTS AROUND THE PRODUCT.

VIBRATION DISCLAIMER

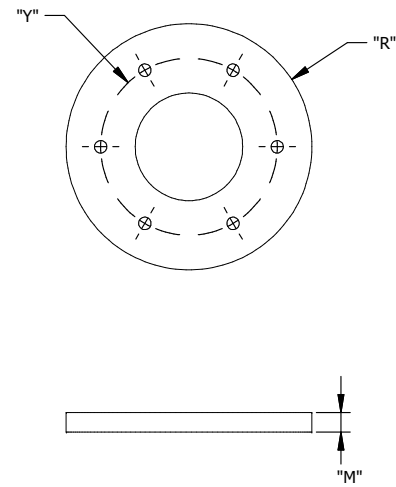

DETAIL 7 BASEPLATE

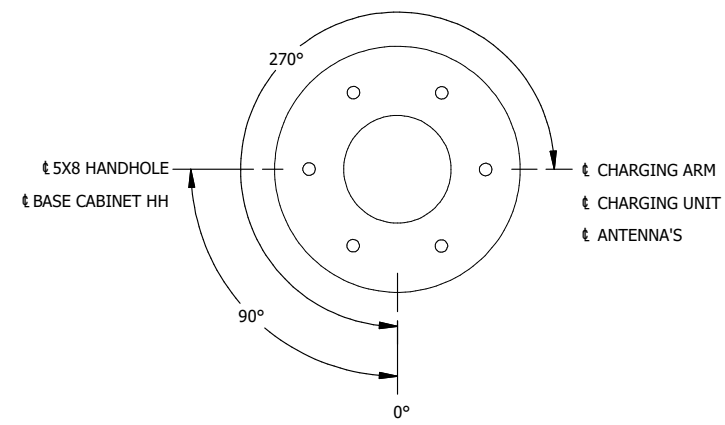

RADIAL INDEX

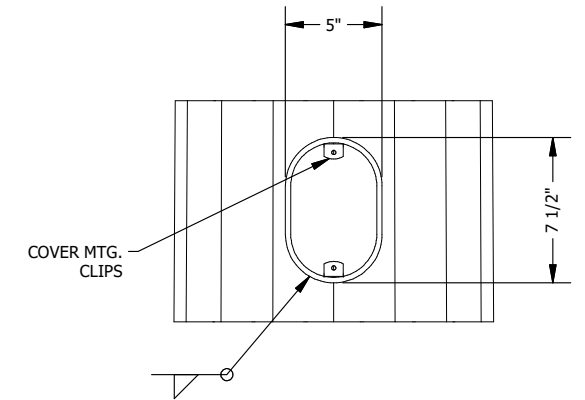

DETAIL 10 4 X 6-1/2 HANDHOLE

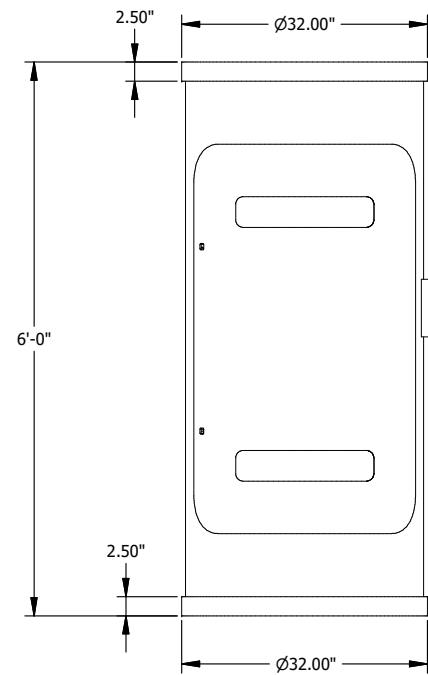
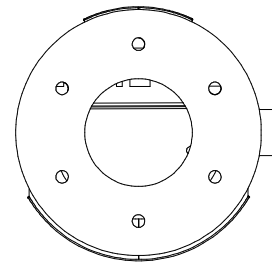

DETAIL 8 BASE CABINET

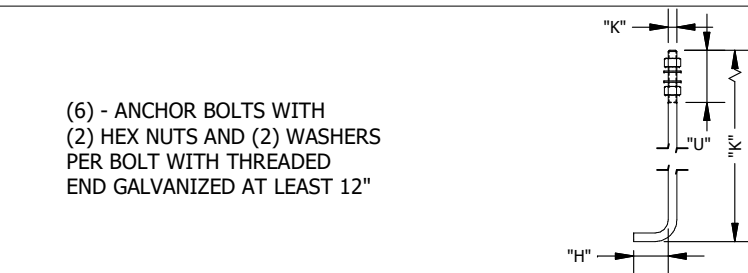
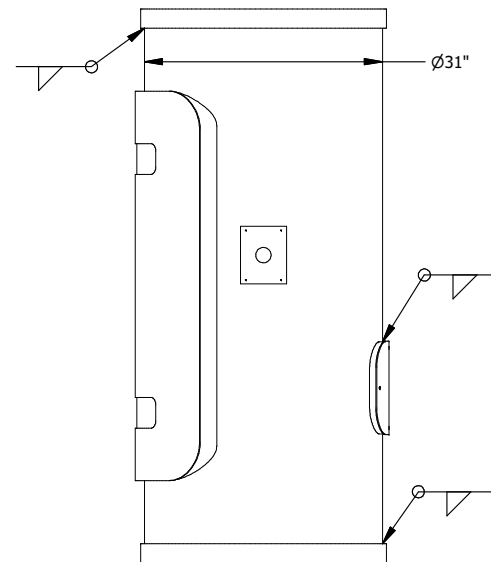

DETAIL 9 ANCHOR BOLT

(6) - ANCHOR BOLTS WITH (2) HEX NUTS AND (2) WASHERS PER BOLT WITH THREADED END GALVANIZED AT LEAST 12"

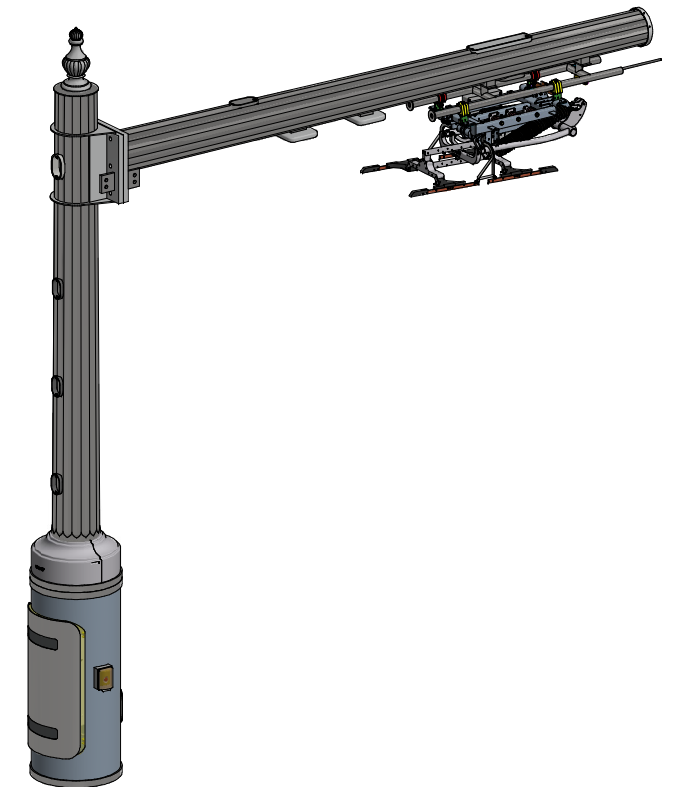
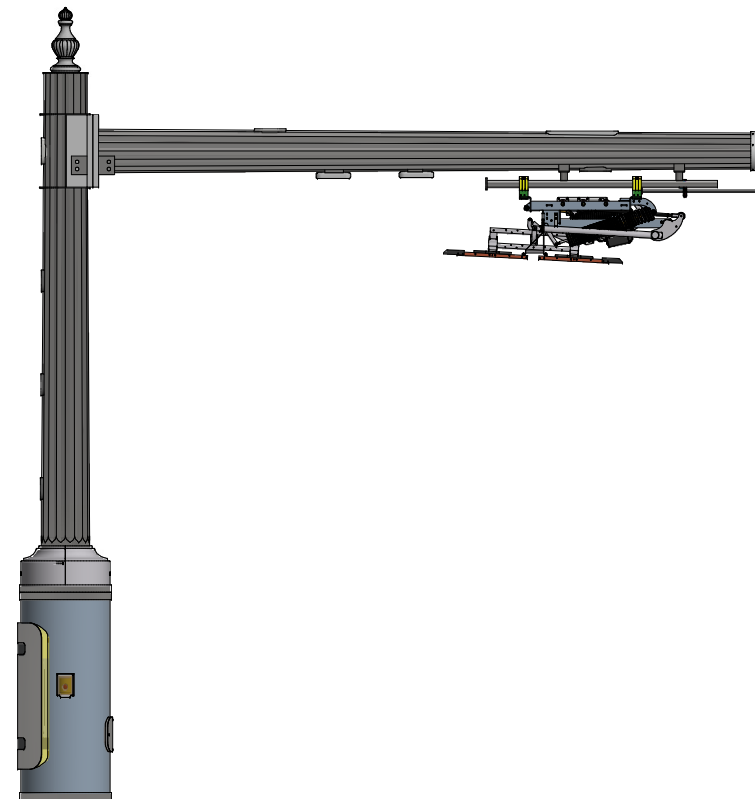

JOB BUS CHARGING  
FLUTED POLE DESIGN  
TITLE BUS CHARGER

VALMONT INDUSTRIES, INC. RESERVES THE RIGHT TO INSTALL VARIOUS, ENGINEER APPROVED, MATERIAL HANGING ACCOMMODATIONS TO FACILITATE THE MANUFACTURING PROCESS.

**valmont**  
Valley, NE 68064  
(402) 359-2201

ORDER NUMBER: 568817-P1  
PAGE NUMBER: 2 OF 2  
DRAWING NUMBER SC568817P1  
REV